

# The Heathwood Collection

## MAIN FLOOR ATTRIBUTES

- 1 10' - 11' Ceilings (as per plan)
- 2 Upgraded custom designed kitchen cabinetry with extra height uppers
- 3 Luxurious granite 3/4" countertops with undermount stainless steel sink & upgraded faucet
- 4 8" "safe and sound" interior doors
- 5 2 1/4" Natural finish oak strip hardwood flooring throughout main floor (except tiled areas)
- 6 Natural finish oak stairs with matching handrail, nosing and pickets
- 7 Luxurious imported ceramic tile flooring in Kitchen, Breakfast Room, Powder Room, Foyer and Laundry Room
- 8 Choice of location for 10 - 4" LED potlights on main level
- 9 Direct vent gas fireplace with painted wood mantle
- 10 Ceramic Kitchen backsplash
- 11 5 1/4" baseboard and 3" intergrated backbend casing
- 12 Stainless steel range hood
- 13 Unique Powder Room pedestal sinks
- 14 2 electrical outlets for future garage door openers
- 15 Low flow toilet
- 16 Central Vac rough-in



# EXQUISITE FINISHES BRING LUXURY AMENITIES TO LIFE



## SECOND FLOOR FEATURES

- 1 9' ceilings (as per plan)
- 2 2 1/4" Natural finish oak strip hardwood flooring in upper hall
- 3 Natural finish oak stairs with matching handrails and pickets to main floor
- 4 Luxurious freestanding soaker tub
- 5 Chrome frame glass shower enclosures with door
- 6 Luxurious imported ceramic tile flooring in all ensuites
- 7 5 1/2" baseboard and 3" integrated backband casing
- 8 Luxury 40 oz broadloom in all bedrooms
- 9 6'8" interior doors
- 10 Low flow toilets

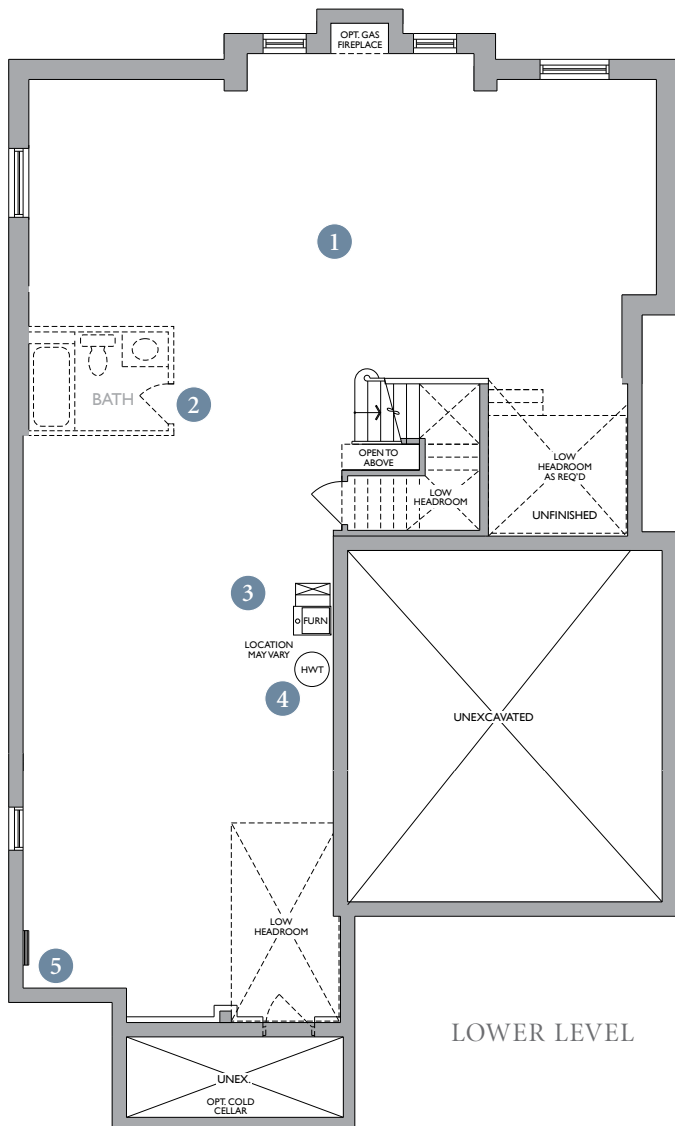
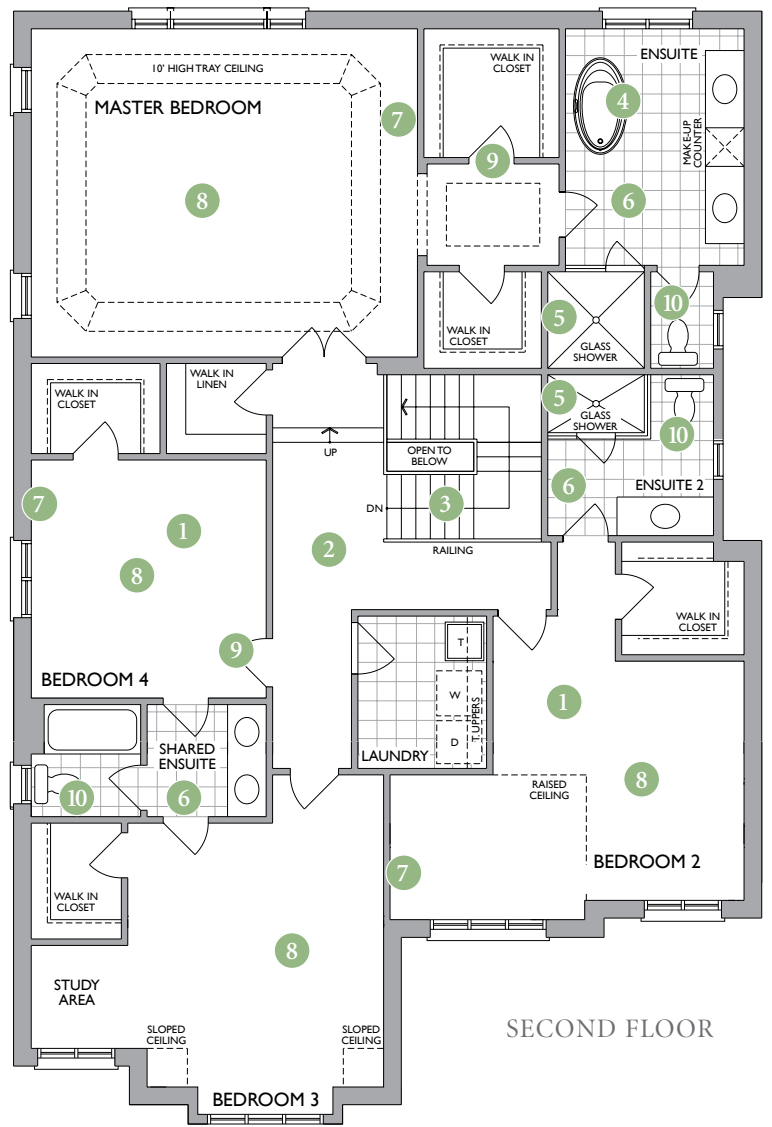

## LOWER LEVEL HIGHLIGHTS

- 1 Unfinished lower level with approx. 7' 8" ceilings\*
- 2 3 piece bathroom rough-in
- 3 96% High Efficiency furnace with ECM motor
- 4 Heat Recovery Ventilator (HRV)
- 5 100 amp Electrical Service

(\*Except where beams and heating equipment are required)